

General Notes :

Legends for hatch	
	Existing Brick wall masonry
	Existing RCC Structure
	Existing Wood+Glass partition
	Open Courtyard land area

R4	19-05-25	Softcopy	GMDC		Tender	KAP
R3	22-02-25	Softcopy	GMDC		Tender	KAP
R2	01-03-24	Softcopy	GMDC		Tender	KAP
R1	27-09-23	Softcopy	GMDC		Tender	KAP
R0	11-07-23	Softcopy	GMDC		Tender	KAP
Rev	Date	Issued	Issued to		Issued for	Author

Key Plan:

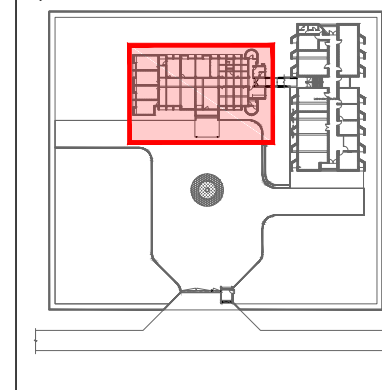

Project: GMDC Township Development

Drawing: Floor Race Way Layout
Office Building_Ground Floor
Sheet 02

Drawing Code: 2310_INT_TD_OFC_TEL_R4

Print Size: A3 Scale: 1:100

File Title: 2310_INT_TD_OFC_TEL_R4

Project Code: MSA 2310	Project Type: Arc & Int	Location: Ambaji
Print Date: 19-May-25	Drawn By: K Parikh	Checked By: K Patel
		Approved By: M Shah



MAMTA SHAH & ASSOCIATES
Architects & Interior Designers
C-12, Chanakyapuri Society,
Chanakyapuri Char Rasta,
New Sana Road, Baroda
Ph. No. +91 265 2712267 / 2710967
mamta@msain.com / www.msain.com

Client:



Gujarat Mineral Development corporation

RACEWAY LEGEND SHEET	
SYMBOL	DESCRIPTION
	200 x 200 MM WIDE & 50 MM DEEP JUNCTION BOX
	350 x 350 MM WIDE & 50 MM DEEP JUNCTION BOX
	150 MM WIDE & 38 MM THREE COMPARTMENT RACEWAY
	300 MM WIDE & 38 MM THREE COMPARTMENT RACEWAY
	DISTRIBUTION BOARD
	ELV RACK

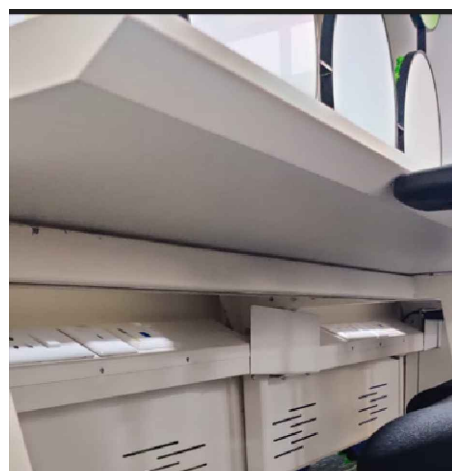

Workstation below Cable race way



Pop up box coating match with table top



Reference Image for Pop up box